

# Set-Up Guide

## In the box

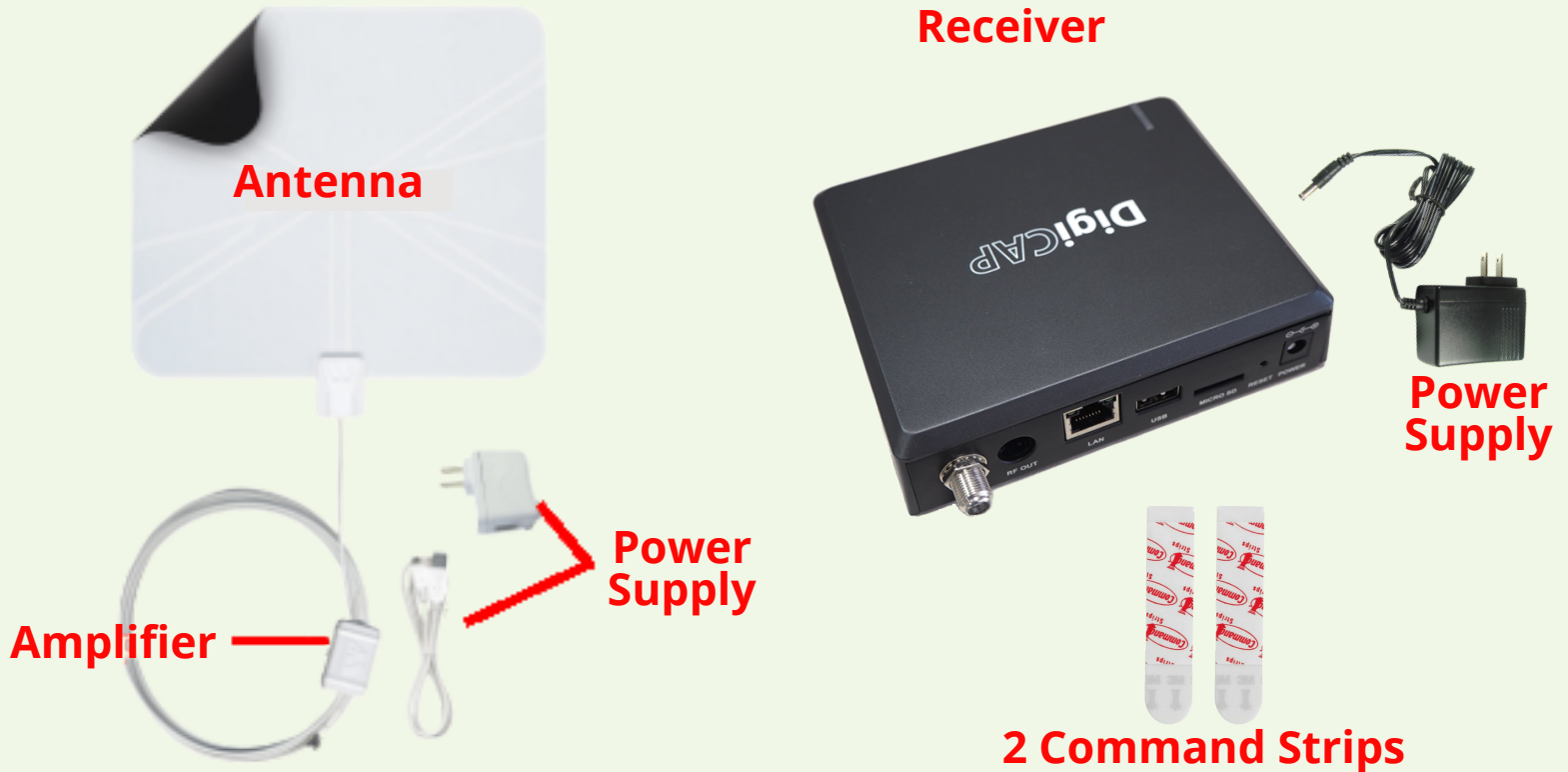

## For Assistance

If you are having trouble setting up your equipment or turning on your antenna, please call 812-352-1921. If after hours, leave a message and someone will get back to you as soon as possible.

# Put It Together



1

Connect the receiver

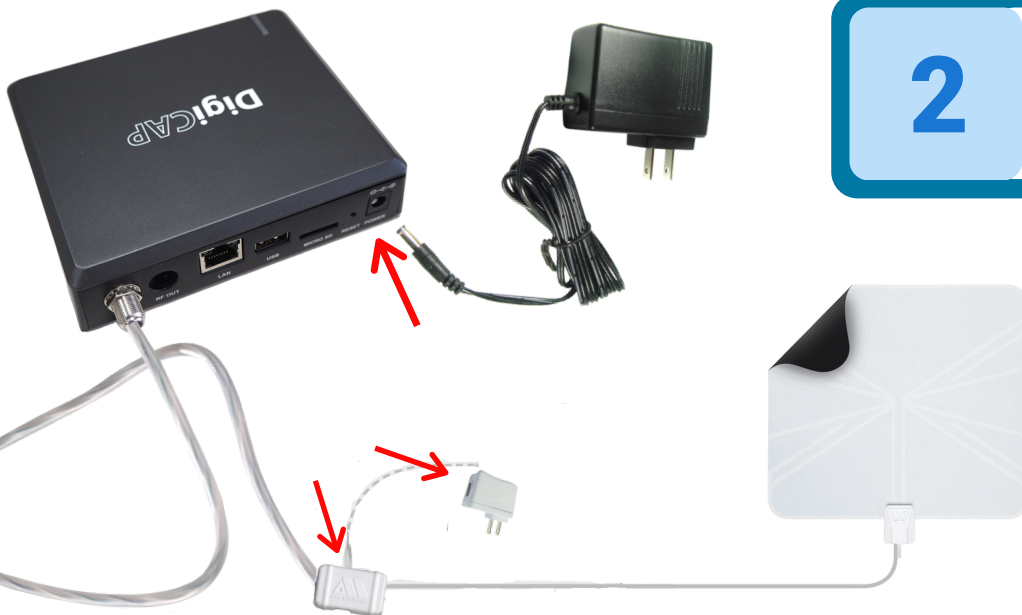

2

Connect the power supply



3

Plug it in

# Tune Your Antenna

1 Power on your device



2 Connect to EduCast Wi-Fi

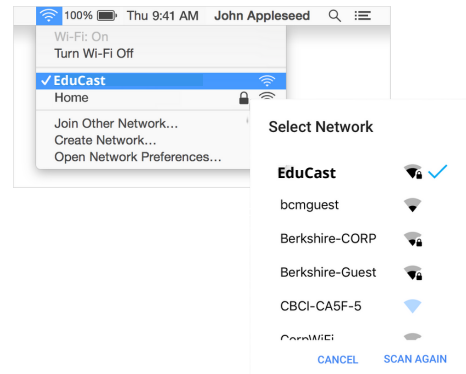

3 Go to the Internet

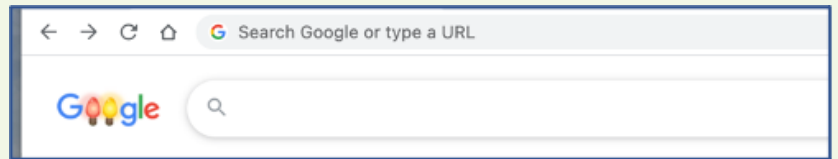

4 Enter This Number

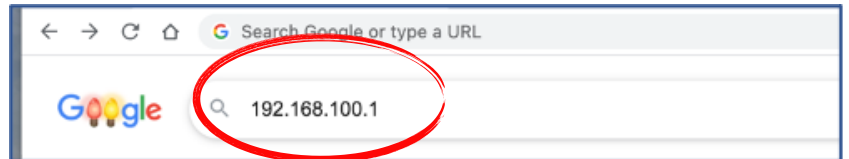

5 Check Status

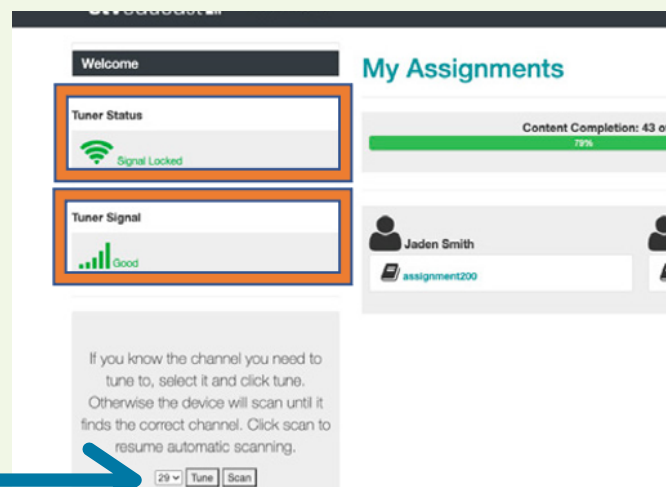

Choose Channel 33 and click Tune.

# Place Your Antenna

## 1 Find a window that is:



on the top floor of your house.



near an outlet.



facing the direction of the PBS transmitter tower in your area.

*Use the map to help you find the tower.*

## 2 Best signal looks like this

**4 green bars**



### If you do not have **4 green bars**:



try it on another window.

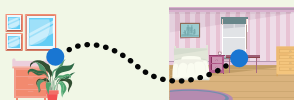

try it in another room.

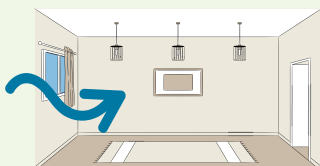

try it on a wall.

# Place Your Antenna, Page 2

- 3** When you have good signal, use the 2 Command strips to put the antenna on the window or wall.



- 4** Always leave your receiver and antenna plugged in.



- 5** Now you are ready for datacasting!



# Antenna Placement Map

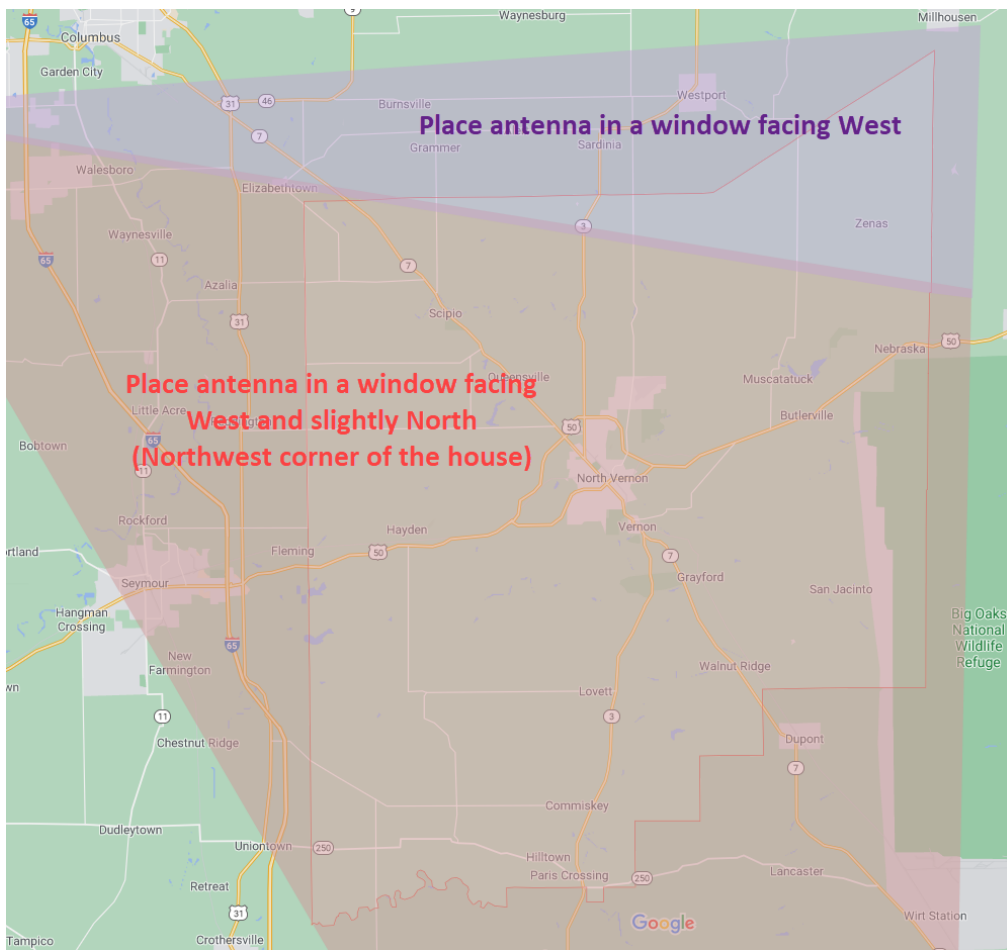
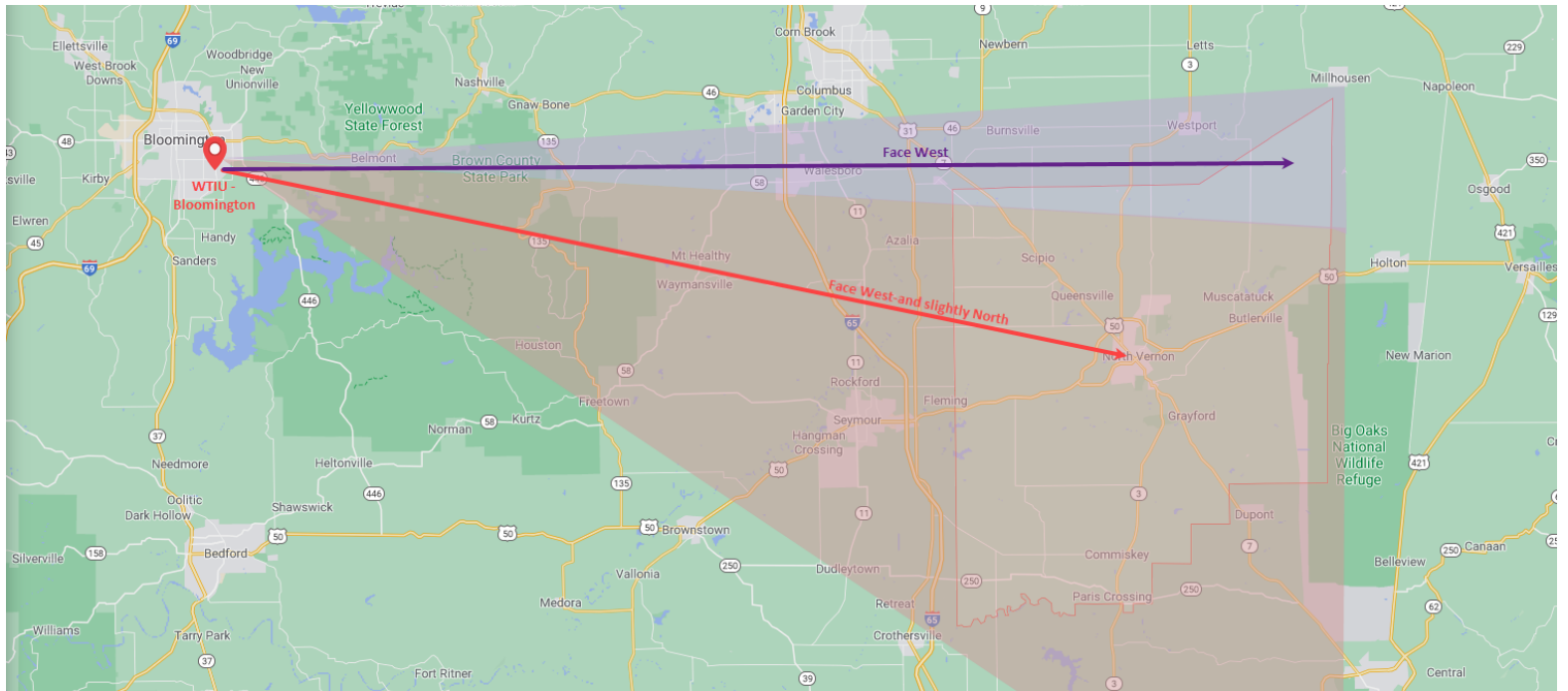

**The datacasting signal will be coming from Bloomington. Based on where you live in the County, you will want the antenna to be in a West or Northwest window.**